



215 COURT STREET

BETWEEN WYCKOFF & WARREN STREETS
COBBLE HILL BROOKLYN

215 COURT STREET

BETWEEN WYCKOFF & WARREN STREETS



SIZE

1,800 SF + Full Basement

POSSESSION

Immediate

TERM

Negotiable

TOP FEATURES

- Turn key built out restaurant in the heart of Cobble Hill Brooklyn.
- Has a full basement , high ceilings and a backyard patio.
- It is situated between Wyckoff and Warren Streets.
- Walking Distance to the Bergen Avenue subway FG stop with annual subway ridership of 3,577,496 and the Borough Hall subway 2,3,4,5 stop annual subway ridership of 10,135,722.

NEIGHBORS

Rag and Bone, Bonobos, Lemongrass ,CVS, Daily Provisions, Chipotle Mexican, Bareburger, Trader Joes

ASKING RENT

Per request

AVAILABILITY

Immediate

TRANSPORTATION



HUGH FINKEL

908.447.7167
hugh@realnewyork.com

SETH KESSLER

330.360.1787
seth@realnewyork.com

REALNY | COMMERCIAL

FLOOR PLAN

215 COURT STREET | BETWEEN WYCKOFF & WARREN STREETS

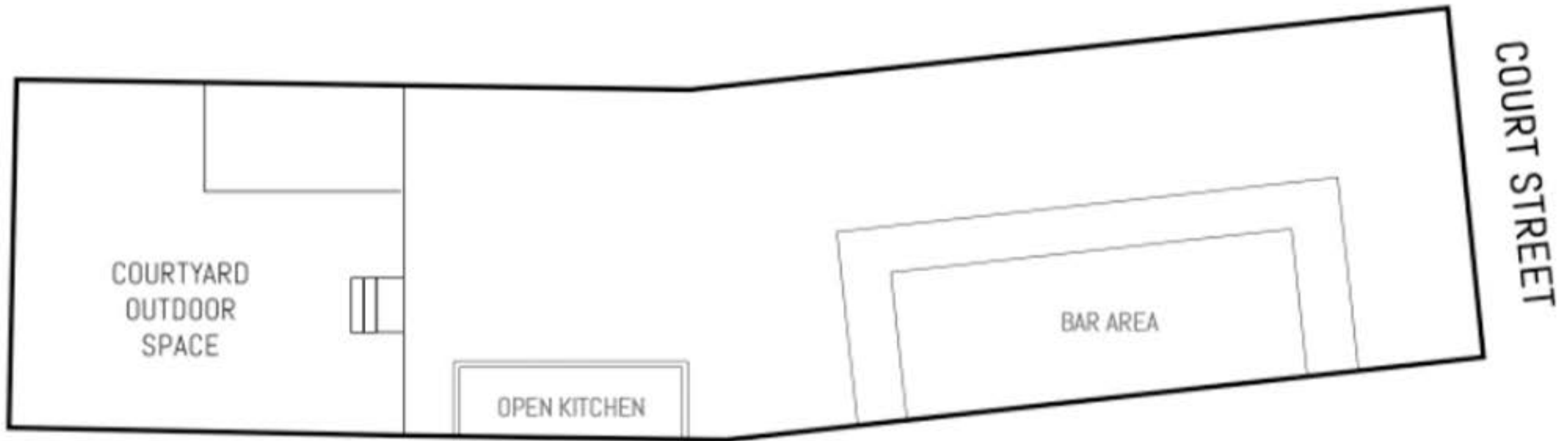

HUGH FINKEL

908.447.7167
hugh@realnewyork.com

SETH KESSLER

330.360.1787
seth@realnewyork.com

REAL^{NY} | COMMERCIAL